

**Robert Band Ltd, Joiner/Building Contractor.**

**Joinery workshop, Caravan Site, Harbour Wynd, Lower Largo. (scale 1:100), Oct. 2018, John Band.**

Robert (Bert) Band was born on the 10<sup>th</sup> October 1934, first son of Neil (cattleman) & Helen (domestic servant) Band (nee Beveridge) at his maternal grandparents small holding, Muirton Hills, Auchterderran, Fife.

After residing on several farms in Fife, the family arrived at Lundin Mill where Neil was cattleman and farm labourer until his retirement.

Robert began his joinery apprenticeship circa 1948 with Robert (Bob) Stout of Aberhill Joinery, cycling from Lundin Mill to his work, daily. In order to buy his tools Robert worked extra hours potato picking etc.

Robert married Catherine Philp at Largo Parish Church on the 9<sup>th</sup> June 1955.

At this date Robert had started his National Service in the Life Guards, trooper Band R. 23125061 seeing action in Egypt during the Suez crisis and on the Island of Cyprus. On returning home in 1957 Robert went back to work for Bob Stout, becoming foreman on several large local authority housing schemes in Buchhaven & Methil.

In 1958 Robert left Stouts and joined Robert (Bob) Donaldson, joiner, Upper Largo, where he stayed until making the decision to become self-employed in 1968. Robert quickly established himself as a contractor with a reputation for first class workmanship, employing his first two men (Bruce Sibbald & Roy Jamieson).

In 1972-73 Robert purchased the Colinsburgh based firm of Barclay Brothers, Builders (foreman, Victor Howie) to compliment his joinery business and became Robert Band Ltd. The business continued to thrive, eventually employing near 30 staff.

However due to a couple of large bad debts owed by customers the business was forced to close in 1984. (Bruce & Victor remained with Robert as foreman of their trades up to 1984.)

Robert Band passed away at St. Andrews Memorial Hospital on the 10<sup>th</sup> February 2009.

½ glazed fire exit (original cottage garage rear door)

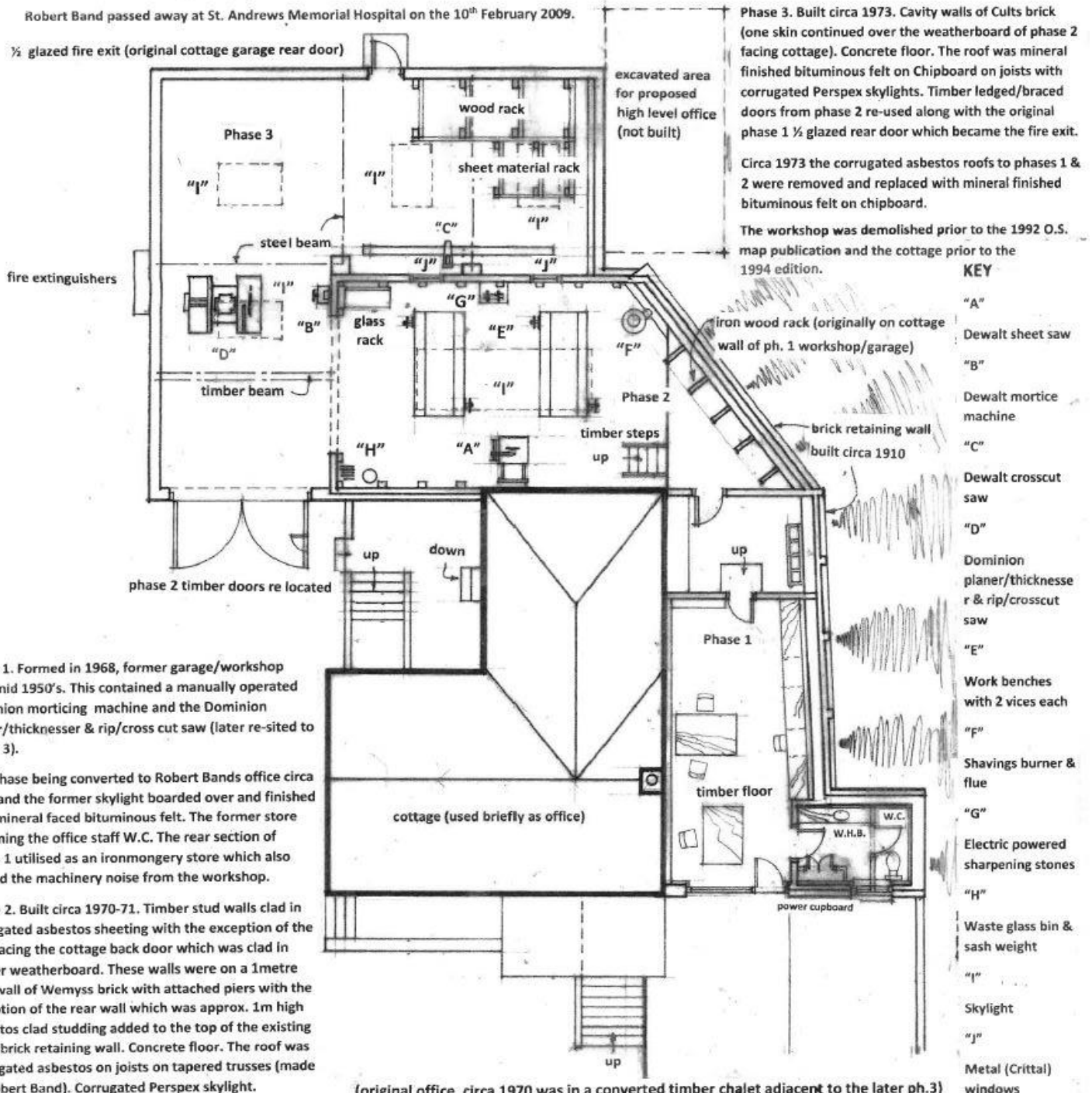

Phase 3. Built circa 1973. Cavity walls of Cults brick (one skin continued over the weatherboard of phase 2 facing cottage). Concrete floor. The roof was mineral finished bituminous felt on Chipboard on joists with corrugated Perspex skylights. Timber ledged/braced doors from phase 2 re-used along with the original phase 1 ½ glazed rear door which became the fire exit.

Circa 1973 the corrugated asbestos roofs to phases 1 & 2 were removed and replaced with mineral finished bituminous felt on chipboard.

The workshop was demolished prior to the 1992 O.S. map publication and the cottage prior to the 1994 edition.

**KEY**

- "A" Dewalt sheet saw
- "B" Dewalt mortice machine
- "C" Dewalt crosscut saw
- "D" Dominion planer/thicknesser & rip/crosscut saw
- "E" Work benches with 2 vices each
- "F" Shavings burner & flue
- "G" Electric powered sharpening stones
- "H" Waste glass bin & sash weight
- "I" Skylight
- "J" Metal (Crittal) windows

Phase 1. Formed in 1968, former garage/workshop built mid 1950's. This contained a manually operated Dominion morticing machine and the Dominion planer/thicknesser & rip/cross cut saw (later re-sited to Phase 3).

This phase being converted to Robert Bands office circa 1978 and the former skylight boarded over and finished with mineral faced bituminous felt. The former store becoming the office staff W.C. The rear section of phase 1 utilised as an ironmongery store which also baffled the machinery noise from the workshop.

Phase 2. Built circa 1970-71. Timber stud walls clad in corrugated asbestos sheeting with the exception of the wall facing the cottage back door which was clad in timber weatherboard. These walls were on a 1metre high wall of Wemyss brick with attached piers with the exception of the rear wall which was approx. 1m high asbestos clad studding added to the top of the existing mass brick retaining wall. Concrete floor. The roof was corrugated asbestos on joists on tapered trusses (made by Robert Band). Corrugated Perspex skylight.

(original office, circa 1970 was in a converted timber chalet adjacent to the later ph.3)